

**ONE HOLE HYLUG™
CODE CONDUCTOR
LONG BARREL WITH
INSPECTION WINDOW**

TYPE YAZ

**UNINSULATED COPPER
COMPRESSION TERMINAL**

UL Listed 90° C,
600 Volts to 35 kV ◆

45° and 90° angles are available.
Please contact Customer Service to order:
1-800-346-4175

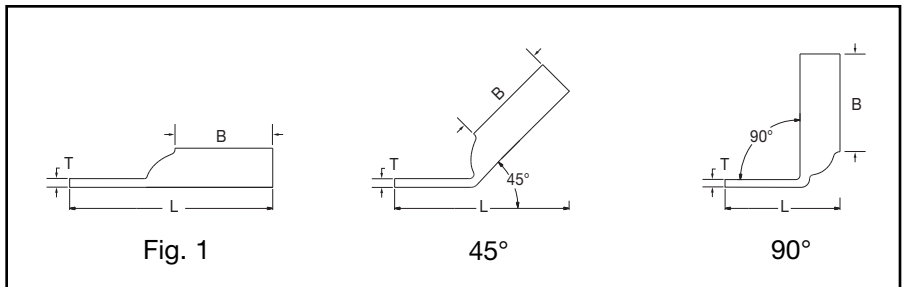
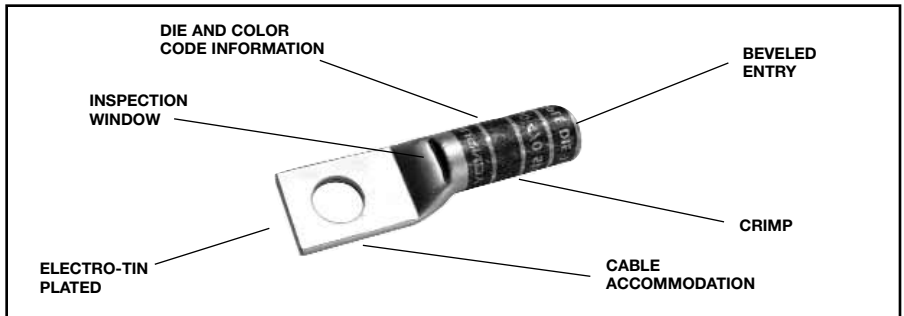

Catalog Number	Fig #	Conductor		Stud Hole Size	Tongue Width	Figure Dimensions			Dieless (# of crimps)	▲ Installation Tooling					Wire Strip Length
		AWG	MM ²			(B)	(T)	(L)		Mechanical MD6, OUR840, MD7-34R	Hydraulic		Color Code	Die Index	
											BCT500HS, Y500CTHS	Y35, Y39, Y750, Y46*, PAT750			
YAZV10TC14	1	#14 - 10 Str #12 - 10 Sol	6	1/4"	.41"	.69"	.05"	1.54"	Y8MRB-1	—	—	—	—	—	3/4"
YAZ8CTC10	1	#8 AWG #8 Weld 37/24 #6 Sol	† 10	#10	.41"	.75"	.08"	1.58"	Y1MRTC (2) MY29-3 (2)	W8CVT (2) W8CRT (2) X8CRT (2)	W8CVT (2) W8CRT (2) X8CRT (2)	U8CRT (2)	Red	49	7/8"
YAZ8CTC14	1			1/4"	.44"	.75"	.08"	1.71"							
YAZ8CTC38	1			3/8"	.58"	.75"	.06"	1.89"							
YAZ6CTC14	1	#6 AWG	—	1/4"	.45"	1.12"	.08"	2.03"	MRC840 (2) Y644HS (1) Y81KFT (1)	W5CVT (2) W5CRT (2) X5CRT (2)	W5CVT (2) W5CRT (2) X5CRT (2)	U5CRT (2) U8CABT (2)	Blue	7 or 374	1-3/16"
YAZ6CTC38	1			3/8"	.58"	1.12"	.06"	2.22"							
YAZ6CTC12	1			1/2"	.83"	1.12"	.12"	2.65"							
YAZ5CTC12	1	#5 AWG	—	1/2"	.83"	1.12"	.12"	2.68"	Y81KFTMBH (1) PAT81KFT-18V (1)	W5CRT (2) W5CVT (2) X5CRT (2)	W5CVT (2) X5CRT (2) W5CRT (2)	U5CRT (2)	Blue	7 or 374	1-3/16"
YAZ4CTC14	1	#4 AWG	—	1/4"	.49"	1.12"	.09"	2.05"	Y1MRTC (4) MY29-3 (2) MY29-11 (2) MRC840 (2) Y644HS (1) Y81KFT (1)	W4CVT (2) W4CRT (2) X4CRT (2)	W4CVT (2) W4CRT (2) X4CRT (2)	U4CRT (2) U6CABT (2)	Gray	8 or 346	1-3/16"
YAZ4CTC38	1			3/8"	.58"	1.12"	.08"	2.23"							
YAZ4CTC12	1			1/2"	.73"	1.12"	.06"	2.50"							

* Use PUADP-1 adapter with U dies in Y46 HYPRESS™.
** P-RT die sets for use in Y46 HYPRESS™ only, PUADP-1 adapter not required.
*** The MM² conductor sizes listed are the recommendations for Class 2 conductor.

† The MM² conductor size listed is for Class 2 and Class 5 conductor.
▲ See tooling section of this catalog for complete tool and die listings.

• Available undrilled. Add suffix U to catalog number (example: YA25U).
◆ For applications greater than 2000 Volts consult cable manufacturer for voltage stress relief instructions.
Note: All dimensions shown are for reference only.

Blue highlighted items are industry standard and most frequently ordered.

Compression Connections

BURNDY®

Copper Compression – Code – Long Barrel – Inspection Window

C-28

ONE HOLE HYLUG™ CODE CONDUCTOR LONG BARREL WITH INSPECTION WINDOW (Continued)

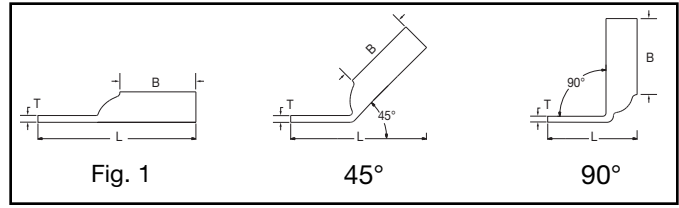

UL Listed 90° C,
600 Volts to 35 kV ◆

45° and 90° angles are available.
Please contact Customer Service to order:
1-800-346-4175



Catalog Number	Fig #	Conductor		Stud Hole Size	Tongue Width	Figure Dimensions			Dieless (# of crimps)	▲ Installation Tooling				Wire Strip Length	
		AWG	MM²			(B)	(T)	(L)		Mechanical MD6, OUR840, MD7-34R	Hydraulic		Color Code		Die Index
											BCT500HS, Y500CTHS	Y35, Y39, Y750, Y46*, PAT750			
YAZ3CTC14	1	#3 AWG #2 Sol	25	1/4"	.55"	1.25"	.09"	2.21"	Y1MRTC (4) MY29-3 (2) MY29-11 (2) MRC840 (2) Y644HS (1) Y81KFT (2) Y81KFTMBH (2) PAT81KFT-18V (2)	W3CRT (2)	W3CRT (2)	U3CRT (2)	White	9	1-5/16"
YAZ3CTC38	1			3/8"	.58"	1.25"	.08"	2.39"							
YAZ3CTC12	1			1/2"	.83"	1.25"	.07"	2.83"							
YAZ2CTC14	1	#2 AWG	35	1/4"	.60"	1.25"	.11"	2.23"	W2CVT (2) W2CRT (2) X2CRT (2)	W2CVT (2) W2CRT (2) X2CRT (2)	U2CRT (2)	Brown	10	1-5/16"	
YAZ2CTC38	1			3/8"	.60"	1.25"	.11"	2.41"							
YAZ2CTC12	1			1/2"	.83"	1.25"	.09"	2.85"							
YAZ1CTC14	1	#1 AWG	50	1/4"	.67"	1.38"	.10"	2.39"	W1CVT (2) W1CRT-1 (2) X1CRT-1 (2)	W1CVT (2) W1CRT-1 (2) X1CRT-1 (2)	U1CRT-1 (2) U4CABT (2)	Green	11 or 375	1-7/16"	
YAZ1CTC38	1			3/8"	.67"	1.38"	.10"	2.57"							
YAZ1CTC12	1			1/2"	.83"	1.38"	.09"	3.01"							
YAZ25TC14	1	1/0 AWG	—	1/4"	.75"	1.38"	.12"	2.42"	MY29-3 (2) MY29-11 (2) MRC840 (4) Y644HS (1) Y81KFT (2) Y81KFTMBH (2) PAT81KFT-18V (2)	W25VT (4) W25RT (4) X25RT (4)	W25VT (4) W25RT (4) X25RT (4)	U25RT (2) U2CABT (2)	Pink	12 or 348	1-7/16"
YAZ25TC516	1			5/16"	.75"	1.38"	.12"	2.47"							
YAZ25TC38	1			3/8"	.75"	1.38"	.12"	2.60"							
YAZ25TC12	1	2/0 AWG	70	1/2"	.83"	1.38"	.12"	3.04"	W26VT (4) W26RT (4) X26RT (4)	W26VT (4) W26RT (4) X26RT (4)	U26RT (2)	Black	13	1-9/16"	
YAZ26TC14	1			1/4"	.83"	1.50"	.12"	2.58"							
YAZ26TC38	1			3/8"	.83"	1.50"	.12"	2.76"							
YAZ26TC12	1	3/0 AWG	—	1/2"	.83"	1.50"	.12"	3.2"	W27RT (4) W27VT (4) X27RT (6)	W27RT (4) W27VT (4) X27RT (6)	U27RT (2)	Orange	14	1-9/16"	
YAZ27TC38	1			3/8"	.90"	1.50"	.12"	2.8"							
YAZ27TC12	1			1/2"	.91"	1.5"	0.12"	3.23"							
YAZ28TC38	1	4/0 AWG	—	3/8"	1.02"	1.62"	0.14"	2.99"	W28VT (4) W28RT (4) X28RT (6)	W28VT (4) W28RT (4) X28RT (6)	U28RT (2)	Purple	15	1-11/16"	
YAZ28TC12	1			1/2"	1.02"	1.62"	0.14"	3.40"							
YAZ29TC38	1	250 kcmil	—	3/8"	1.10"	1.62"	0.16"	2.99"	W29VT (4) X29RT (8)	W29VT (4) W29RT (4) X29RT (6)	U29RT (2)	Yellow	16	1-11/16"	
YAZ29TC12	1			1/2"	1.10"	1.62"	0.16"	3.43"							

* Use PUADP-1 adapter with U dies in Y46 HYPRESS™.
** P-RT die sets for use in Y46 HYPRESS™ only, PUADP-1 adapter not required.

*** The MM² conductor sizes listed are the recommendations for Class 2 conductor.
▲ See tooling section of this catalog for complete tool and die listings.

• Available undrilled. Add suffix U to catalog number (example: YA25U).
◆ For applications greater than 2000 Volts consult cable manufacturer for voltage stress relief instructions.
Note: All dimensions shown are for reference only.

Blue highlighted items are industry standard and most frequently ordered.

**ONE HOLE HYLUG™
CODE CONDUCTOR
LONG BARREL WITH
INSPECTION WINDOW**
(Continued)

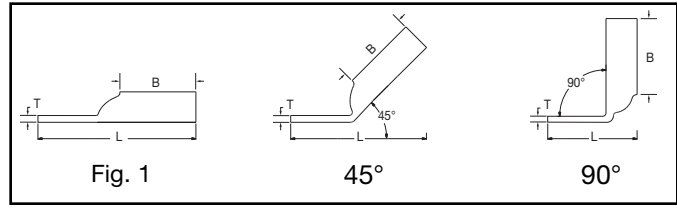

UL Listed 90° C,
600 Volts to 35 kV ◆



45° and 90° angles are available.
Please contact Customer Service to order:
1-800-346-4175

Catalog Number	Fig #	Conductor		Stud Hole Size	Tongue Width	Figure Dimensions			Dieless (# of crimps)	▲ Installation Tooling				Wire Strip Length		
		AWG	MM ²			(B)	(T)	(L)		Mechanical MD6, OUR840, MD7-34R	Hydraulic		Color Code		Die Index	
											BCT500HS, Y500C7HS	Y35, Y39, Y750, Y46*, PAT750				
YAZ30TC38	1	300 kcmil	150	3/8"	1.20"	2"	.16"	3.42"	Y644HS (1)	W30VT (4)	W30RT (4)	U30RT (4)	White	17 or 298	2-1/16"	
YAZ30TC12	1			1/2"	1.20"	2"	.16"	3.85"		W31VT (4)	W31RT (4)	U31RT (4)				
YAZ31TC38	1	350 kcmil	185	3/8"	1.29"	2"	0.18	3.45"	Y81KFT (3)	W31VT (4)	W31RT (4)	U31RT (4)	Red	18 or 324	2-1/16"	
YAZ31TC12	1			1/2"	1.29"	2"	0.18	3.89"								W32VT (4)
YAZ32TC38	1	400 kcmil	—	3/8"	1.40"	2.12"	.19"	3.62"	PAT81KFT-18V (3)	W32VT (4)	W32RT (4)	U32RT (4)	Blue	19 or 470	2-3/16"	
YAZ32TC12	1			1/2"	1.40"	2.12"	.19"	4.06"								W33VT (4)
YAZ33TC12	1	450 kcmil	—	1/2"	1.48"	2.12"	.21"	4.14"	Y644HS (1)	W34VT (4)	W34RT (4)	U34RT (4)	Brown	20 or 299	2-5/16"	
YAZ34TC38	1	500 kcmil	240	3/8"	1.55"	2.25"	.23"	3.85"	Y81KFT (4)	W34VT (4)	W34RT (4)	U31ART (4)	Yellow	21	2-11/16"	
YAZ34TC12	1			1/2"	1.55"	2.25"	.23"	4.29"								—
YAZ35TC12	1	550 kcmil	—	1/2"	1.65"	2.62"	.25"	4.7"	PAT81KFT-18V (4)	—	—	U36RT (4)	Green	22 or 472	2-3/4"	
YAZ36TC38	1	600 kcmil	300	3/8"	1.74"	2.69"	.26"	4.55"	Y644HS (1) Y81KFT (4) Y81KFTMBH (4) PAT81KFT-18V (4)	—	—	U36RT (4)	Green	22 or 472	2-3/4"	
YAZ36TC12	1	600 kcmil	300	1/2"	1.74"	2.69"	.26"	4.80"		—	—	U37RT (4)	Orange	23	2-7/8"	
YAZ37TC12	1	650 kcmil	—	1/2"	1.80"	2.81"	.27"	4.95"		—	—	U38RT (4)	Pink	400	2-7/8"	
YAZ38TC12	1	700 kcmil	—	1/2"	1.84"	2.81"	.27"	4.97"		Y644HS (1) Y81KFT (4)	—	—	U39RT (4)	Black	24	2-15/16"
YAZ39TC38	1	750 kcmil	—	3/8"	1.91"	2.88"	.27"	4.82"								
YAZ39TC12	1			1/2"	1.91"	2.88"	.27"	5.07"								
YAZ39NT12	1	750 kcmil	—	1/2"	1.63"	2.88"	.27"	5.07"		Y81KFTMBH (4)	—	—	P39RT (4) **	—	—	—
YAZ40TC12	1	800 kcmil	400	1/2"	1.98"	2.94"	.30"	5.14"		PAT81KFT-18V (4)	—	—	P40RT (4) **	Orange	25	3"
YAZ41TC12	1	850 kcmil	—	1/2"	2.01"	2.94"	.31"	5.16"		—	—	—	Gold	26	3"	
YAZ44TC38	1	1000 kcmil	500	3/8"	2.19"	3.00"	.33"	5.09"		—	—	—	P44RT (4) **	White	27	3-1/16"
YAZ44TC12	1			1/2"	2.19"	3.00"	.33"	5.33"								
YAZ45TC12	1	1250 kcmil	—	1/2"	2.46"	3.19"	.38"	5.63"		—	—	—	P45RT (6) **	Yellow	29	3-1/4"
YAZ453TC12	1	1300 kcmil	—	1/2"	2.53"	3.19"	.39"	5.66"	—	—	—	Orange	30	2-1/16"		
YAZ46TC12	1	1500 kcmil	—	1/2"	2.69"	3.19"	.40"	5.73"	—	—	—	P46RT (6) **	Green	31	3-5/16"	
YAZ47TC12	1	1750 kcmil	—	1/2"	2.90"	3.44"	.42"	6.07"	—	—	—	Gray	33	3-1/2"		
YAZ48TC12	1	2000 kcmil	—	1/2"	3.10"	3.44"	.46"	6.14"	—	—	—	Brown	34	3-1/2"		

* Use PUADP-1 adapter with U dies in Y46 HYPRESS™.
 ** P-RT die sets for use in Y46 HYPRESS™ only, PUADP-1 adapter not required.
 *** The MM² conductor sizes listed are the recommendations for Class 2 conductor.

▲ See tooling section of this catalog for complete tool and die listings.
 • Available undrilled. Add suffix U to catalog number (example: YA25U).

◆ For applications greater than 2000 Volts consult cable manufacturer for voltage stress relief instructions.
Note: All dimensions shown are for reference only.